

CAPTURE CLAW PAINTER HOOKS

HOOKS
SAFETY QUICK RELEASE HOOKS



HPHA 2,5 / 5 / 7

On-load release painter hook and capture claw for fast rescue crafts, RIBs, MOBs, working boats and other types of boats.

HOOK

HPHA

CAPTURE CLAW HOOKS

A Henriksen Capture Claw is placed in the bow of e.g a MOB boat and can be used as both a ramp capture claw hook and a Painter hook for normal davit launch and recovery. This makes the hook very versatile for multi launch operations.

The HPHA are designed for boats with a total weight of up to 10 000 kg. Our guidelines dictates that the painter hook rating (SWL) should be at least half of the total weight of the boat.

Our HPHA hooks are operated with a remote control handle. This makes it easy for the operator in the helms mans position to have full control over the boat and thereby reducing operational risk. Alternatively, the HPHA also has a manual release at the hook.

RAMP OPERATION

The HPHA hooks can, if used together with a catch system, be used as a RAMP hook. The HPHA can catch and secure itself to a horizontally suspended catch rope. A typical Launch and recovery operation from a ramp would be as follows:

Launch

1. Crew and boat is made ready to release while the boat is in the ramp.
2. The HPHA is released with the remote release handle.
3. The boat slides down the ramp and out into sea.

Recovery

1. The boat align itself with the ramp on the mother vessel.
2. The boat drives up the ramp towards a suspended catch line.
3. The HPHA connects and lock on to the catch line, and the boat is securely fastened to the mother vessel.

PAINTER OPERATION

THE HPHA can also work as a normal Painter hook. See chapter for painter hooks for more information. HPHA are designed to catch a suspended rope, but as a painter hook it can be linked with a steel ring or a rope.



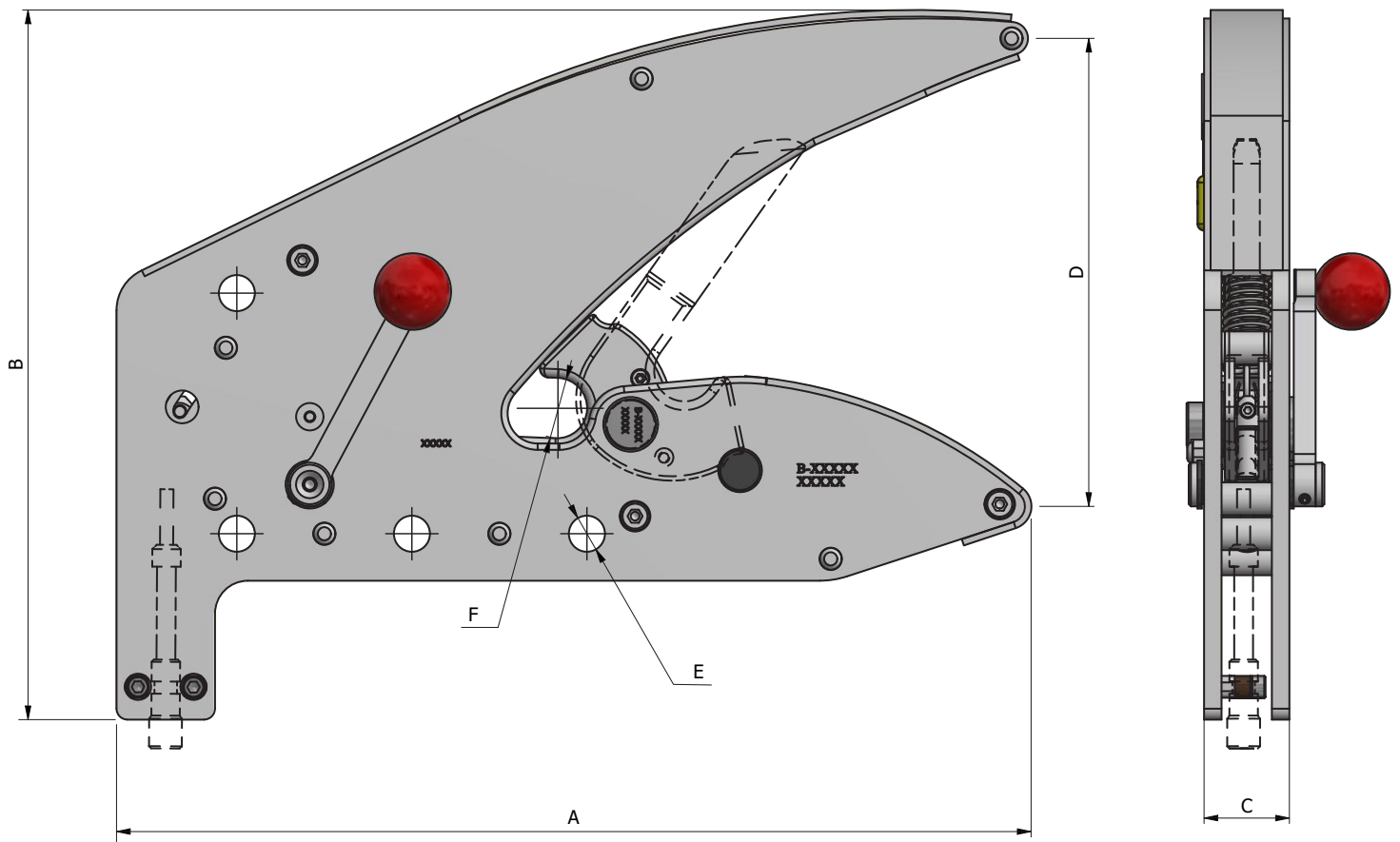

PART NO.	HOOK	SWL	A	B	C	D	E	F	WEIGHT	SAFETY FACTOR
HH000164	HPHA 2,5	2 500 kg	418	324	39	213	Ø16,5	Ø25	11,0 kg	4
HH003095	HPHA 5,0	5 000 kg	768	528	90	428	Ø20,5	Ø55	29,6 kg	4
HH000332	HPHA 7,0	7 000 kg	666 ¹	378 ¹	55	200 ¹	Ø24,5	Ø55	25,5 kg	6 ²

Materials	High quality stainless steel
Warranty	5 years (When the re-certification and annual inspection is followed)
Documentation	Certificates, Installation-, Operation-, and Maintenance Manual
Packaging	Wooden case
Optional Accessories	<ul style="list-style-type: none"> Henriksen Painter Ring Integrated Henriksen System (IHS)

⁽¹⁾ May vary depending on size of custom guide pieces.

⁽²⁾ HPHA 7 is type approved according to DNV-ST-0498.